



Office / Commercial Space for Lease

\$1.25 / SF / Month



**455 E. Artesia Blvd
Long Beach, CA**

LEASING HIGHLIGHTS

- 6,000 of Rentable Square Footage
- Great North Long Beach Location
- Extremely High Traffic Count
- On-Site Parking / Elevator Access
- Building is Visible from 91 and 710 Fwy
- Property is Zoned LBCCA
- Signalized Corner
- Gated Secure Property

James A Antonucci & Michael Pesci
Re/max Commercial & Investment Realty
550 South Hope St. Suite 500
Los Angeles, CA 90071
BRE Lic# 01822661 & #01274379

Direct Line: (213) 233-4374 & (213) 233-4364
Cell Phone: (818) 381-6601 & (213) 820-1335
Email: Jamesa@remaxcir.com
Mpesci@remaxcir.com
Fax: (213) 769-5002

Office Building on Artesia Blvd

Photos



MICHAEL PESCI & JAMES A ANTONUCCI
SENIOR INVESTMENT ASSOCIATE AND INVESTMENT ASSOCIATE
550 S. HOPE ST., STE. 500 LOS ANGELES, CA 90071 PH (213) 233-4374 FAX (213) 769-5002



Office Building on Artesia Blvd

Photos



MICHAEL PESCI & JAMES A ANTONUCCI
SENIOR INVESTMENT ASSOCIATE AND INVESTMENT ASSOCIATE

550 S. HOPE ST., STE. 500 LOS ANGELES, CA 90071 PH (213) 233-4374 FAX (213) 769-5002



Office Building on Artesia Blvd

Photos



MICHAEL PESCI & JAMES A ANTONUCCI
SENIOR INVESTMENT ASSOCIATE AND INVESTMENT ASSOCIATE

550 S. HOPE ST., STE. 500 LOS ANGELES, CA 90071 PH (213) 233-4374 FAX (213) 769-5002



Office Building on Artesia Blvd

Photos



MICHAEL PESCI & JAMES A ANTONUCCI
SENIOR INVESTMENT ASSOCIATE AND INVESTMENT ASSOCIATE

550 S. HOPE ST., STE. 500 LOS ANGELES, CA 90071 PH (213) 233-4374 FAX (213) 769-5002



Office Building on Artesia Blvd

Photos



MICHAEL PESCI & JAMES A ANTONUCCI

SENIOR INVESTMENT ASSOCIATE AND INVESTMENT ASSOCIATE

550 S. HOPE ST., STE. 500 LOS ANGELES, CA 90071 PH (213) 233-4374 FAX (213) 769-5002



Office Building on Artesia Blvd

Photos



MICHAEL PESCI & JAMES A ANTONUCCI

SENIOR INVESTMENT ASSOCIATE AND INVESTMENT ASSOCIATE

550 S. HOPE ST., STE. 500 LOS ANGELES, CA 90071 PH (213) 233-4374 FAX (213) 769-5002



Office Building on Artesia Blvd

Photos



MICHAEL PESCI & JAMES A ANTONUCCI
SENIOR INVESTMENT ASSOCIATE AND INVESTMENT ASSOCIATE

550 S. HOPE ST., STE. 500 LOS ANGELES, CA 90071 PH (213) 233-4374 FAX (213) 769-5002



Office Building on Artesia Blvd

Photos



MICHAEL PESCI & JAMES A ANTONUCCI
SENIOR INVESTMENT ASSOCIATE AND INVESTMENT ASSOCIATE

550 S. HOPE ST., STE. 500 LOS ANGELES, CA 90071 PH (213) 233-4374 FAX (213) 769-5002



Office Building on Artesia Blvd

Photos



MICHAEL PESCI & JAMES A ANTONUCCI

SENIOR INVESTMENT ASSOCIATE AND INVESTMENT ASSOCIATE

550 S. HOPE ST., STE. 500 LOS ANGELES, CA 90071 PH (213) 233-4374 FAX (213) 769-5002



Office Building on Artesia Blvd

Aerial View



MICHAEL PESCI & JAMES A ANTONUCCI
SENIOR INVESTMENT ASSOCIATE AND INVESTMENT ASSOCIATE

550 S. HOPE ST., STE. 500 LOS ANGELES, CA 90071 PH (213) 233-4374 FAX (213) 769-5002



455 E. Artesia Blvd, Long Beach, CA

First Floor - AVAILABLE



Michael Pesci

Vice President of Investments

RE/MAX Commercial & Investment Realty

550 South Hope Street, Suite #500, Los Angeles, CA 90071

(213) 233-4364 Direct

(213) 820-1335 Cell

(213) 623-4433 Fax

(213) 817-1000 ext 104 Office

mpesci@remaxcir.com

BRE License #01274379

James Antonucci

Senior Investment Associate

RE/MAX Commercial & Investment Realty

550 South Hope Street, Suite #500, Los Angeles, CA 90071

(213) 233-4374 Direct

(818) 381-6601 Cell

(213) 769-5002 Fax

(213) 817-1000 ext 114 Office

jamesa@remaxcir.com

BRE License #011822661

Office Building on Artesia Blvd

Parcel Map

7115 | 1
SCALE 1" = 200'

2009

Copyright
2009
RE/MAX
REALTY
INC.

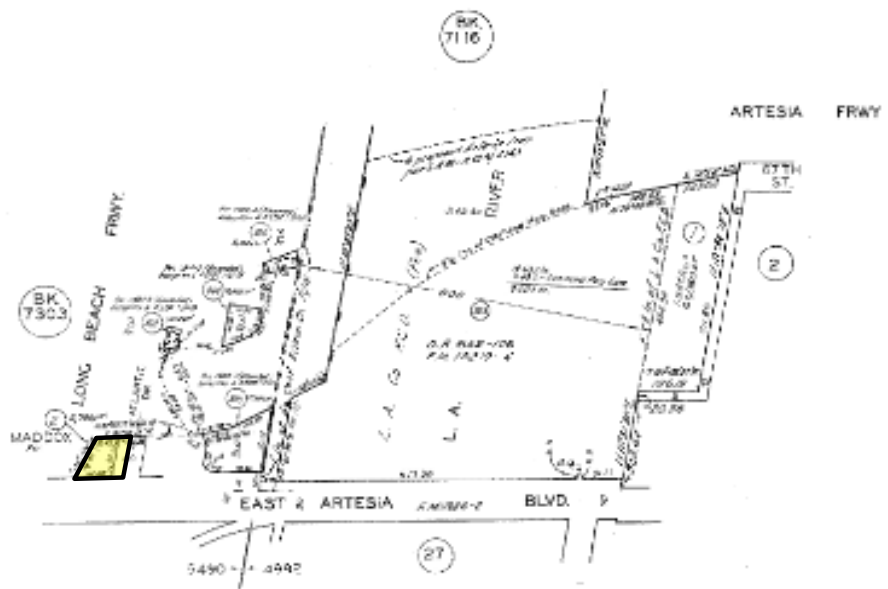

CODE
5490
0492

FOR PREC. ASSMT. SEE:
714 - 89

HELLMAN TRACT M.R. 2-524-525
SAN PEDRO RANCHO D.C.C. 1894, C.F. 28
PROPERTY OF SOUTHERN CALIFORNIA EDISON
CO. LTD. MAP NO. 2 O.M. 1-40-51

ASSESSOR'S MAP
COUNTY OF LOS ANGELES, CALIF.

MICHAEL PESCI & JAMES A ANTONUCCI
SENIOR INVESTMENT ASSOCIATE AND INVESTMENT ASSOCIATE

550 S. HOPE ST., STE. 500 Los Angeles, CA 90071 PH (213) 233-4374 Fax (213) 769-5002

